



Kombi - Aufsteckfräserdorne DIN 6358

SK AD/B

Combi shell mill holder DIN 6358

Porte-fraises à double usage pour fraises à entraînement par clavette ou tenon DIN 6358

Kombine Malafa DIN 6358

FORM AD/B

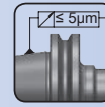

STANDARD
G 6.3
15.000
min⁻¹

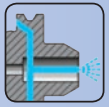

SPECIAL
max.
G 2.5
40.000
min⁻¹

Bestell-Nr. Order Nr. Référence Sipariş Nr.	SK	d	A	L1	L3	D	D1	Euro
403.10.16.55	SK 40	16	55	-	17	32	-	
403.10.16.100	SK 40	16	100	-	17	32	-	
403.10.16.130	SK 40	16	130	-	17	32	-	
403.10.16.160	SK 40	16	160	88	17	32	39	
403.10.16.200	SK 40	16	200	120	17	32	40	
403.10.22.55	SK 40	22	55	-	19	40	-	
403.10.22.100	SK 40	22	100	-	19	40	-	
403.10.22.130	SK 40	22	130	-	19	40	-	
403.10.22.160	SK 40	22	160	88	19	40	46,5	
403.10.22.200	SK 40	22	200	120	19	40	48,5	
403.10.27.55	SK 40	27	55	-	21	48	-	
403.10.27.100	SK 40	27	100	-	21	48	-	
403.10.27.130	SK 40	27	130	-	21	48	-	
403.10.27.160	SK 40	27	160	-	21	48	-	
403.10.27.200	SK 40	27	200	-	21	48	-	
403.10.32.60	SK 40	32	60	-	24	58	-	
403.10.32.100	SK 40	32	100	-	24	58	-	
403.10.32.130	SK 40	32	130	-	24	58	-	
403.10.32.160	SK 40	32	160	-	24	58	-	
403.10.32.200	SK 40	32	200	-	24	58	-	
403.10.40.60	SK 40	40	60	-	27	70	-	

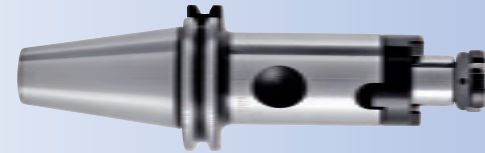
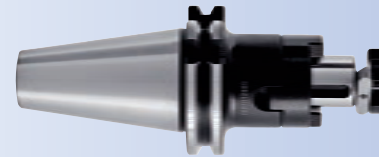
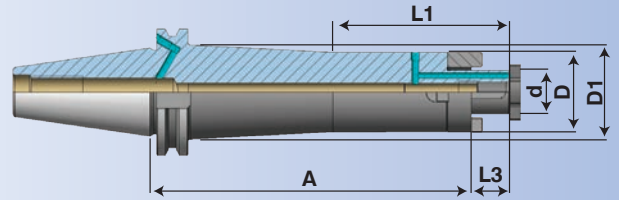

Lieferumfang : Inklusive Paßfeder, Mitnehmerring und Fräseranzugschraube
Included : Milling cutter retention, screw, drive key
with tapered hole for push-out screw, combination drive ring
Inclus : Clavette, bague d'entraînement et vis de serrage
Teslim Şekli : Alın civatası, kaması ve tırnaklı pulu ile birlikte

Zubehör / Accessories / Accessoires / Yedekler



Mitnehmerringe DIN 6366
Clutch drive rings to DIN 6366
Bague d'entraînement DIN 6366
Tırnaklı pul DIN 6366



Fräseranzugschrauben DIN 6367
Drawn in bolt DIN 6367
Vis de serrage DIN 6367
Alın sıkma civatası DIN 6367



Paßfeder
Drive key
Ressort de passage
Kama



Spannschlüssel DIN 6368 für Aufsteckdorne
Wrench DIN 6368
Clé de serrage DIN 6368
Alın civatası sıkma anahtarları DIN 6368