

Porte-pinces E long - Spannzangenhalter E lang - Collet chucks E long

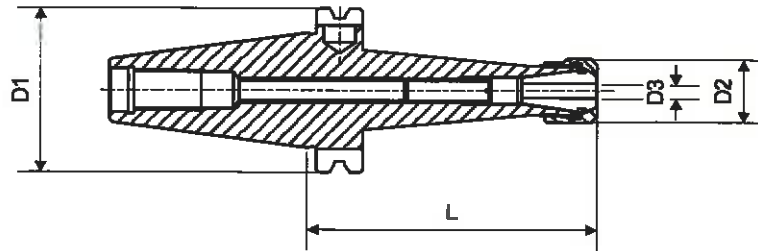





équilibré sur demande
ausgewuchtet auf Anfrage
balanced on request

voir page 105.2
nach Seite 105.2
see page 105.2

arrosage par le centre
Kühlung durch das Zentrum
cooling through center

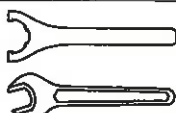
caractères gras : inclus dans la livraison
Fettschrift : im Lieferumfang inbegriffen
bold script : included in delivery

M	DIN 6499 A+B	pince Spannzange collet		Page 221
N	DIN 6499 D	écrou Mutter nut		Page 223
O		clé pour l'écrou Mutternschlüssel spanner for the nut		Page 223
P		vis de réglage Anschlagschraube adjusting screw		
Q	DIN 69872-A 13 tirant DIN 69872-A 19 Zugbolzen	retention knob		Page 167

Gr.	Art.	D1	D2	D3	L	M	N	O	P	Q
ISO30	61-16376	50	25	0.5-10	80	75-16200 75-16300 ET1-16...	61-16710	-	61-16903	89-12030
ISO40	61-16306	63.55	25	0.5-10	100	75-16200 75-16300 ET1-16...	61-16710	-	87-90015	61-99121
	61-20306	63.55	30.5	0.5-13	100	75-20200 75-20300 ET1-20...	61-20710	-	61-25902	61-99121
	61-25306	63.55	42	0.5-16	100	75-25200 75-25300 ET1-25...	61-25730	61-25800	87-90014	61-99121
	61-32306	63.55	50	1.5-20	100	75-32200 75-32300 ET1-32...	61-32730	61-32800	87-90014	61-99121
	61-40306 26)	63.55	63	2-26	100	75-40200 75-40300 ET1-40...	61-40730	61-40800	87-90014	61-99121

26) Sur demande
Auf Anfrage
On request