

# MINI-F<sup>FIX</sup> LED

24V-AC/DC  
100÷240V-AC

3W  
6.000°K      40.000 h

RoHS RAEE CONFORMITY



IP65



EUROPEAN INDUSTRIAL COMPONENTS

2015/05 miniF-001



MN03 L40-F500-24ACDC  
MN03 L40-F500-100240AC

MN03 L40-F700-24ACDC  
MN03 L40-F700-100240AC

## HIGH PERFORMANCES

- ▣ Up to 85% energy saving
- ▣ Low performing heat
- ▣ Zero maintenance
- ▣ Aluminium adjustable head with high resistance glass
- ▣ Easily adjustable and vibration-resistant flexible arms
- ▣ Resistant to coolants and lubricants
- ▣ Complies with Directives 2006/95/EC, 2004/108/EC and 2006/42/EC as required by Normative EN 1387



# MINI-F LED IP65

24V-AC/DC  
100-240V-AC

3W  
6.000°K 40.000 h

RoHS RAEE CONFORMITY



## MINI-F LED 24V-AC/DC, 3W

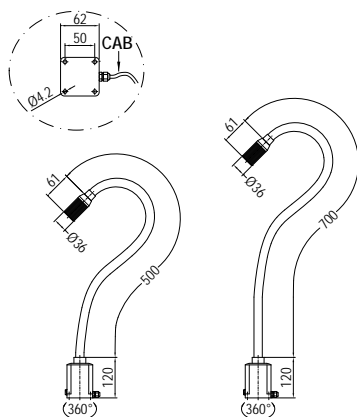

MN03 L40-F500-24ACDC

MN03 L40-F700-24ACDC

## MINI-F LED 100-240V-AC, 3W

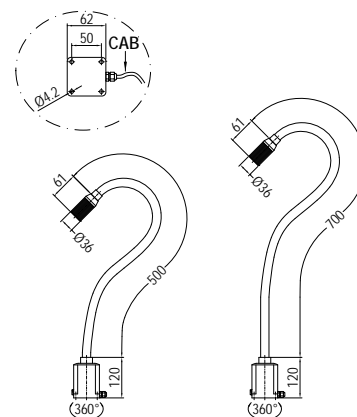

MN03 L40-F500-100240AC

MN03 L40-F700-100240AC

### 2 voltage options:

- 24V-AC/DC with LED driver built-in the base and 2-pole cable
- 100-240V-AC with LED driver built-in the base and cable with 10A Euro plug

### Optional accessories:

mounting clamp, angle plate and magnetic base

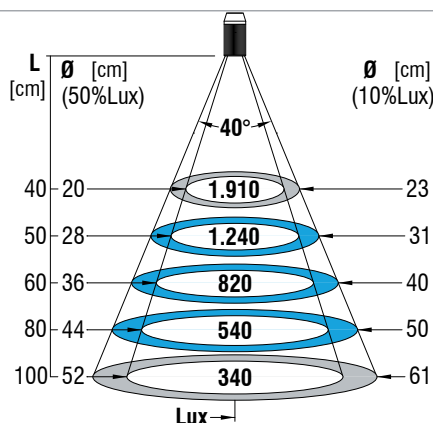

## MINI-F LED 24V-AC/DC

STANDARD

CODE	Vin	WxLed	CAB. mt	Kg
MN03 L40-F500-24ACDC	24V	3Wx1	CV 02	0.75
MN03 L40-F700-24ACDC	AC/DC		1.80	1.00

## MINI-F LED 100-240V-AC

STANDARD

CODE	Vin	WxLed	CAB. mt	Kg
MN03 L40-F500-100240AC	100-240V	3Wx1	SP 04	0.75
MN03 L40-F700-100240AC	AC		1.80	1.00

## OPTIONS

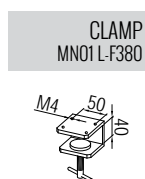

J C03

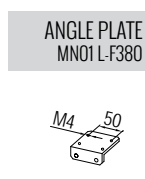

J L05

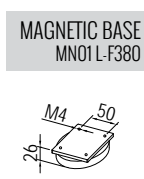

J M01